

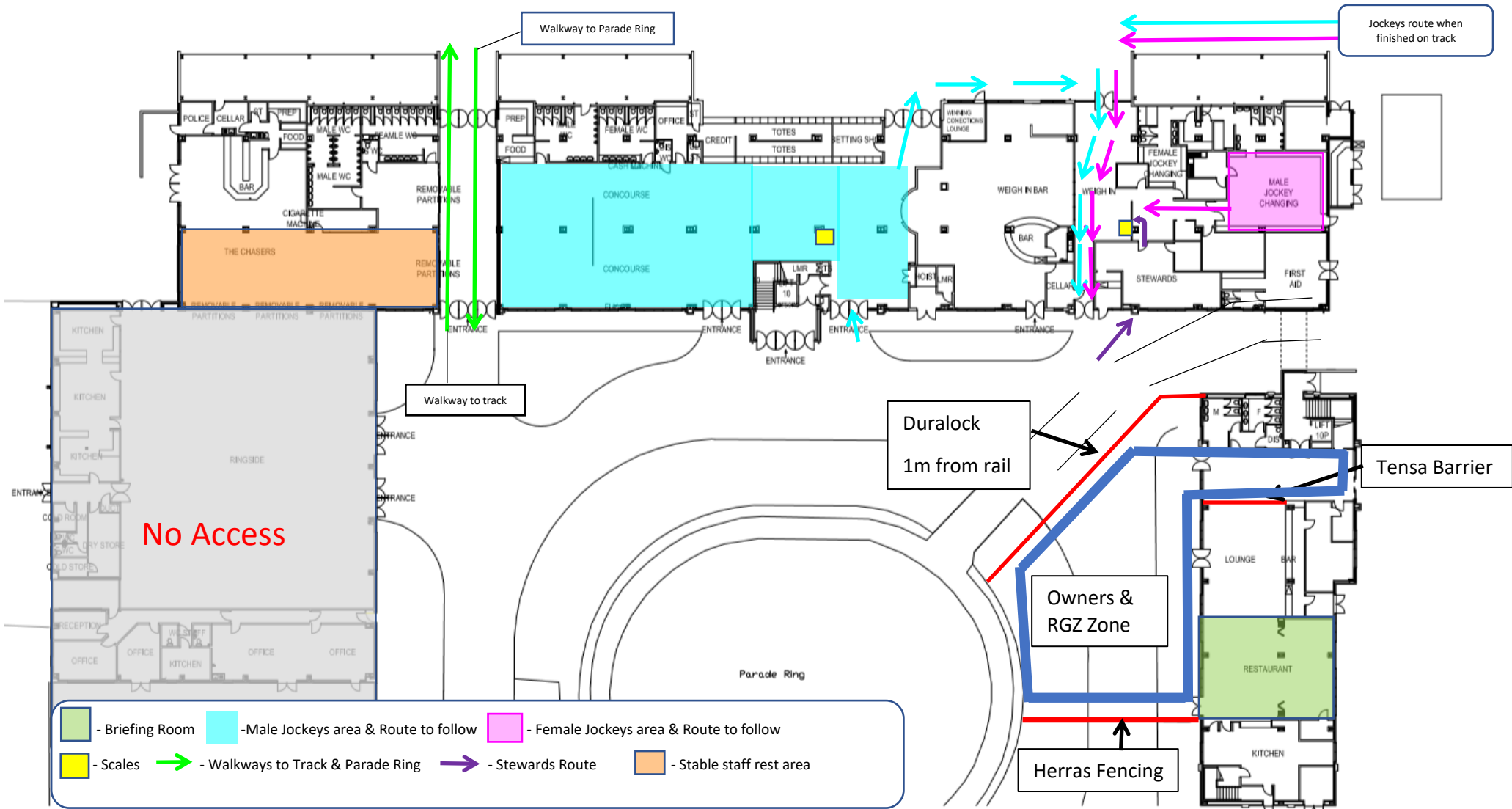

## Wolverhampton Racecourse – Behind Closed Doors Racing Owners Facilities

- **Arrival** will be via the Main Entrance, at the entrance to the “Racing Zones” , you will be asked to show your Photo ID (mandatory) and pass a temperature test given by our PPE wearing staff. You will also sign in through the Pass System. These procedure’s may take a little longer than usual, but the measures have been put in place to ensure the safety of all those attending on the day.
- **Parking** is in Hotel Car Park and will be signed on site.
- The Racing Behind Closed Doors **Entrance** The Owners Entrance will open 1 hour before the first race.
- The new **Owners Enclosure** (please refer this link (<https://www.southwell-racecourse.co.uk/southwell-race-course/owners-and-trainers/>) includes:
  - The Sunbeam suite on the First floor accessed from the Hotel Lobby, please note, food is currently provided free of charge to all those attending behind closed doors at ARC Racecourse race meetings. It is a slightly different offering to our normal delivery due to restrictions on service. No food or drink can currently be purchased at Wolverhampton Racecourse.
  - Access to the outside of the Parade Ring in Front of the Hotel.
  - Elevated viewing from our balconies and steppings trackside from the sunbeam suite.
  - Whilst enclosures will be separated, provision will be made for Owners to be able to speak in person with both Trainer and Jockey.
- The Owners Enclosure does not provide access to the Winners Enclosure or Pre-Parade Ring, but can easily be seen.



# 1<sup>st</sup> Floor Owners & RGZ Participants Zone

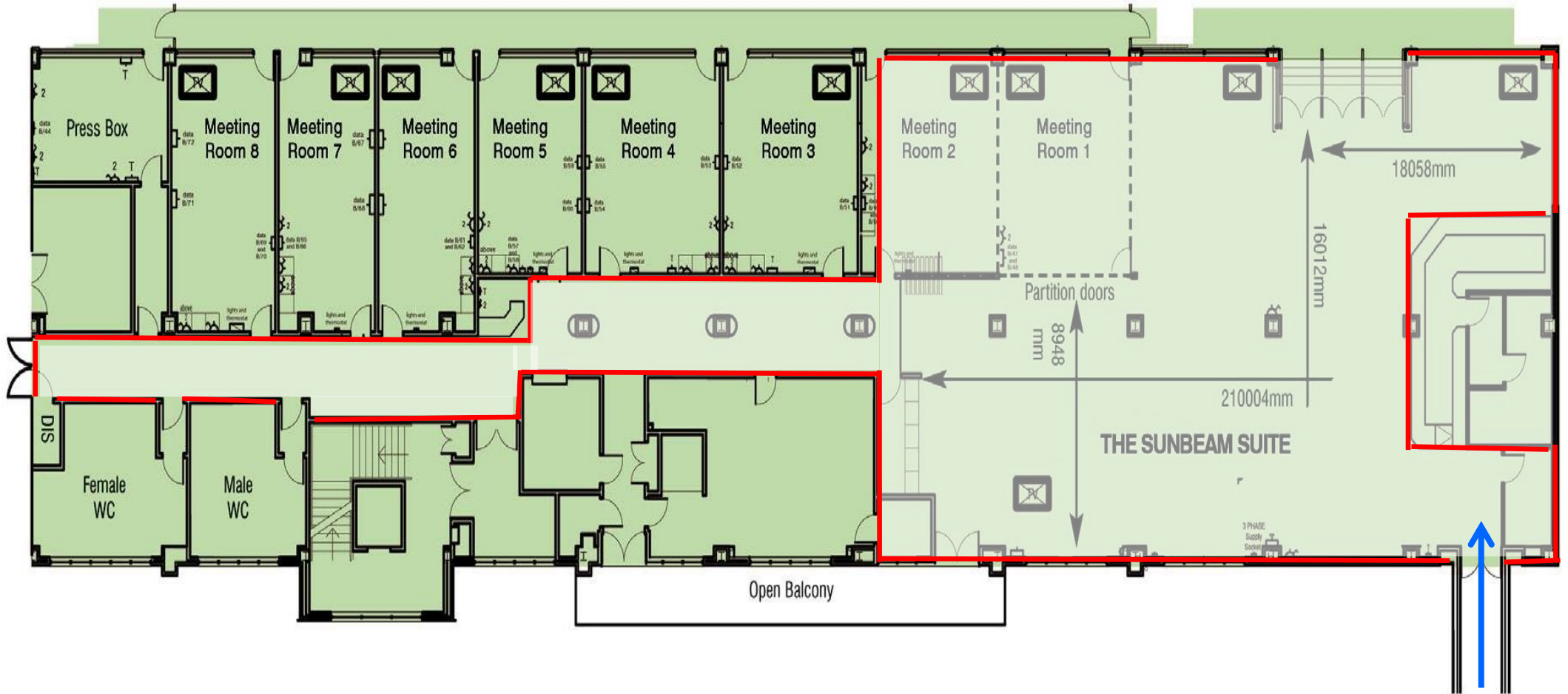

## Owners & RGZ Participants Viewing Area

